

Service Support Spirit

How to solve machine does not arcing—Scout2

→ Problem : The machine does not arcing,

Solution overview: 1. Power does not ARC start.

2. The machine does not signal arcing;

Problem analysis:

✳ Test the plasma power source

Solution: The plasma and the machine are connected by four wires, They are: ARC Start, ARC Start, ARC+ ARC-; as shown in the figure.

Short-circuit A and B of plasma power side, if arc start, the plasma power source is ok, otherwise plasma power source problem;

NOTE: You can directly short-circuit the arcing signal on the plasma power supply.

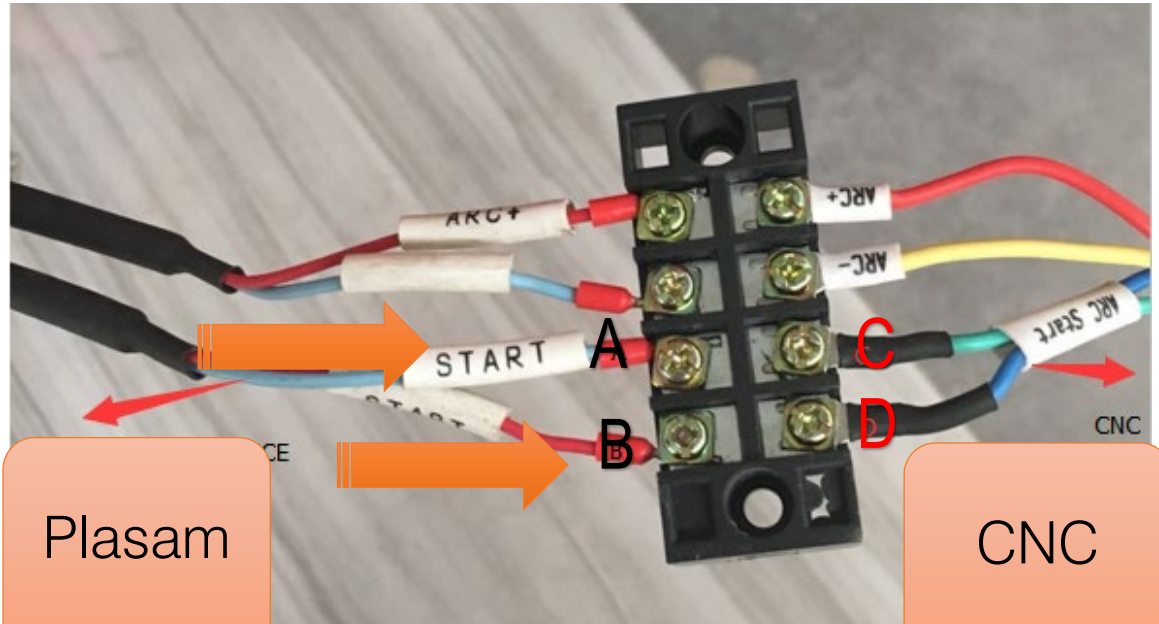

Take powermax45XP as an example:

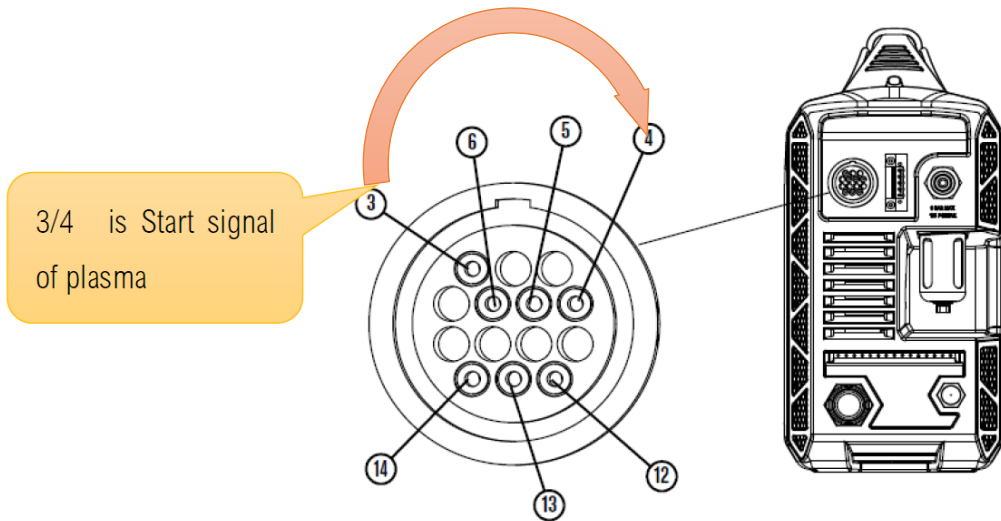

Problem analysis:

- ✦ Check THC and CNC; Power the machine, Press **【Piercing】** Button on the CNC panel or **【ARCING TEST】** Button on the THC panel

Check THC of ARCON light is on or not and output ARCING Signal.





Solution: Keep pressing **【ARCING TEST】** Button on the THC panel, If **【ARCON】** light is on , At the same time, there is has an output arcing signal on the THC board.

--Check ARCING Signal ,Keep pressing **【ARCING TEST】** Button, **At the same time**, Use a multimeter to check.

If there is a ON between ARCSTART_1 and ARCSTART_2. Prove that the THC is working;

If there is a OFF between ARCSTART_1 and ARCSTART_2. Prove that the THC is Bad ,Please change new THC;

Test CNC ARCING signal:

Keep pressing **【Piercing】** Button on the CNC panel, If **【ARCON】** light is on , At the same time, there is has an output arcing signal on the THC board.

--Check ARCING Signal ,Keep pressing **【Piercing】** Button, At the same time, Use a multimeter to check.

If there is a ON between ARCSTART_1 and ARCSTART_2. Prove that the CNC is working;

If there is a OFF between ARCSTART_1 and ARCSTART_2. Prove that the CNC is Bad ,Please contact ARCBRO;

Service Support Spirit

