

## Service Support Spirit

### How to solve the unstable movement of the machine's beam -- Y axis

➔ Problem: The unstable movement of the machines beam, Need Check and Adjust the Fitness of Beam;

Solution overview: 1. Check & adjust the Meshing situation between the rack and gear;  
2. Check & adjust the tightness between the V wheel and ball guider;

#### Problem analysis:

✳ 1. Check & adjust the Meshing situation between the rack and gear;

**Solution:** Step 1- Turn on the machine power supply,

Step 2- Turn on the offline button and move the beam by hand to make the controller at the middle of the beam.

Step 3- Turn off the offline button and Open the controller box,

Step 4- Find the motor of beam axis, then Use your hand holding the beam to push and drag it forward and backward, meanwhile feel the power of the movement:

if you can't move it at all, means it's too tight, you need make the Motor position lower to make the tightness between rack and pinion proper;

If you can move it very easy, you need make the Motor position higher to make the gap smaller between the rack and pinion until you get a proper bit.

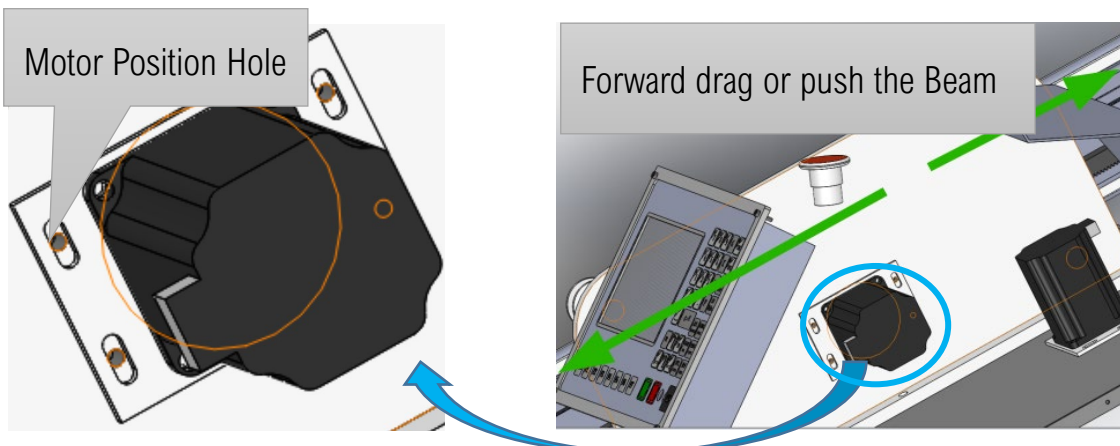

## Service Support Spirit

### Problem analysis:

- ✳ 1. Check & adjust the tightness between the V wheel and ball guider;

**Solution:** Step 1- Take off the beam cover aside of the controller box,

Step 2- Rotate the two V wheels and feel if you can turn them along the shaft with proper effort of your hand?

Step 3- If you find the tightness is not proper (too loose that you can turn the wheel freely? Or too tight you could not turn it at all?)

Step 4- Adjust the tightness between the V wheel and the shaft as the photo instruction below (holding the screw head and fix the other end for proper tightness.)

