

ARCBRO®

Spark SERIES

CNC Plate Cutting Machine Installation Manual



Operator Manual

ARCBRO | Revision 2 |

English Date of issue:

August, 2021

Technical Support

Thank you very much to choose ARCBRO product, our whole engineer department work for you since the day you receive machine. When you have any questions during assembling or operating, it is free to contact us by Call, Email, Online help 7x24 hours.

Wish you enjoy a wonderful CNC cutting travel.

ARCBRO CNC Technical Support & Solutions

7x24 Hours

+86-10-65798995

support@arcbro.com

www.arcbro.com/about-arcbro-cnc-cutting-solutions/



MACHINE ▾ PLASMA/FLAME CUTTER ▾ BLOG ▾ SUPPORT ▾ ABOUT US ▾ 🔍

Contact

by arcbro / August 7, 2015

Contact Us for CNC solutions



E-mail: Please leave message to us by live chat —

>>

Contact ARCBRO Portable CNC Cutting Machine

We will reply as soon as possible



Address: Xinfang Industrial Park, No.218, ChaoYang District, Beijing 100024, China

Tel: 0086 10 65798995

Fax: 0086 10 65790867

Share this:



Our System

- Contact
- Why ARCBRO

7/24 Hours Te

Any question, an

Tel: +86-17610780555

Email: info@arcbro.com

Follow Us



Installation steps

Basic logic: Follow the Number of each Parts to install.

I: Installation of the base

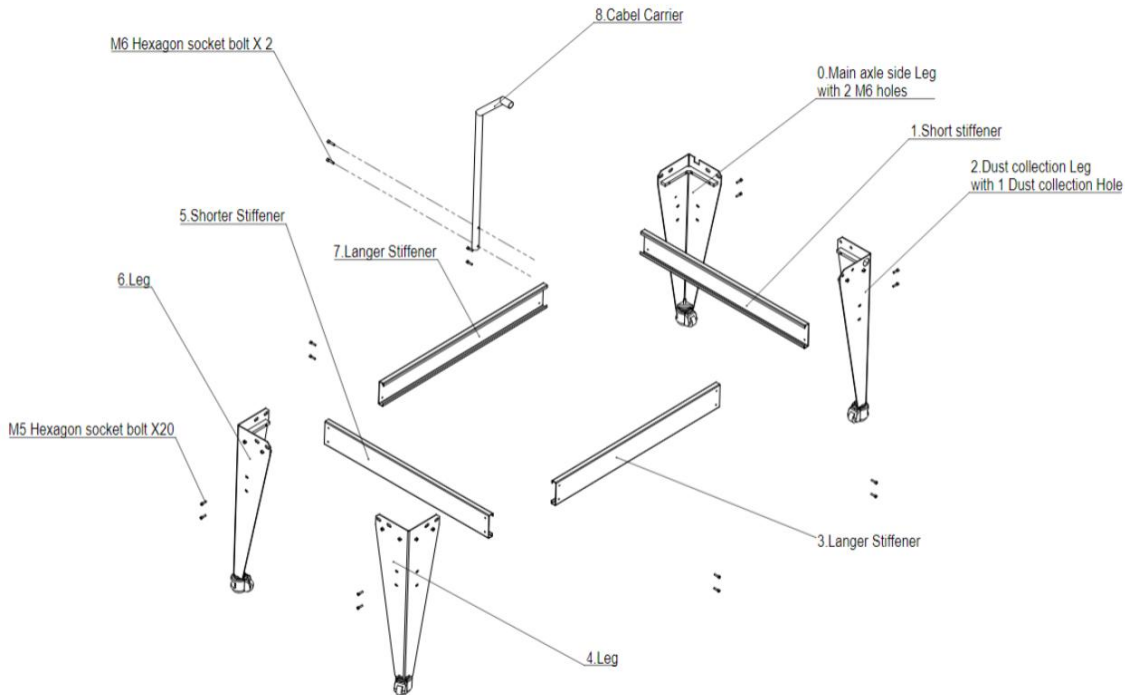

Step1: Use (1) Short stiffener to connect (0) Main axle side Leg and (2) Dust collection Leg. (Pay attention to distinguish the two legs and the shorter stiffener; M5 Hexagon socket bolt)

Step2: Use (3) Longer stiffener to connect (2) Dust collection Leg and (4) Leg. (M5 Hexagon socket bolt)

Step3: Use another (5) shorter stiffener to connect (4) Leg and (6) Leg. (M5 Hexagon socket bolt)

Step4: Use another (7) Longer stiffener to connect (6) Leg and (0) Leg. (M5 Hexagon socket bolt)

Step5: Use 2 M6 Hexagon socket bolt to fix the (8) cable carrier and the (0) Main axle side Leg.

II: Installation of Main frame

Unique Solution

WWW.ARCBRO.COM

Service Support Spirit

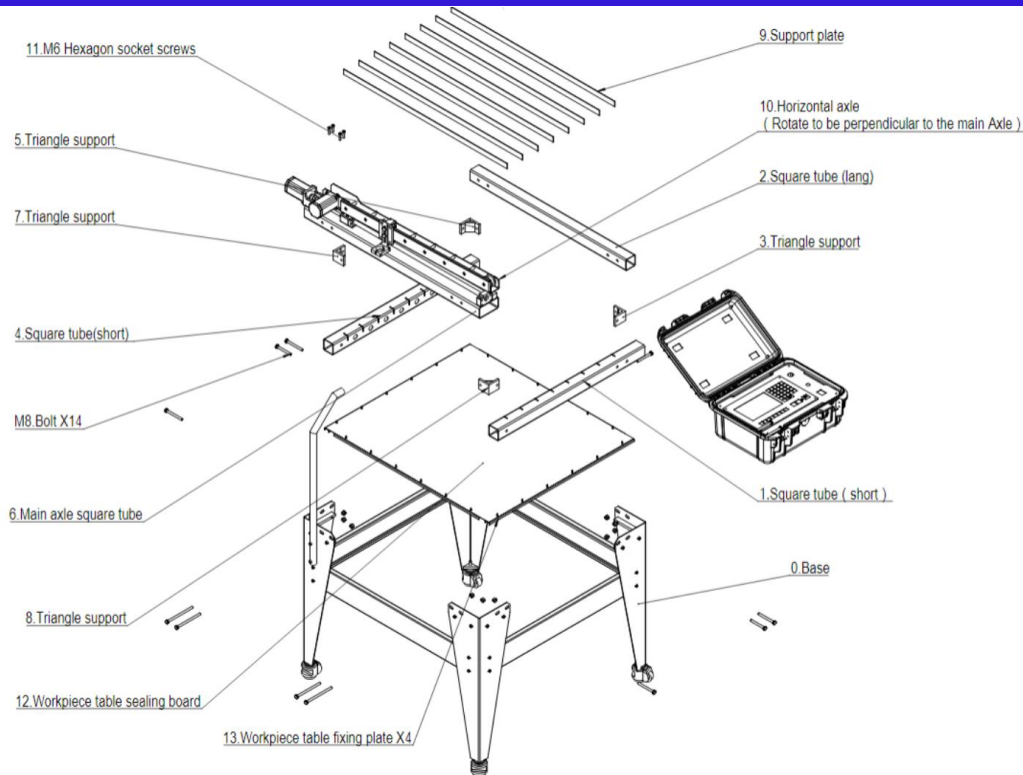

Basic logic: Follow the Number of each Parts to install.(from0-12)

Step1:Use 4 M8 bolts to fix(3)Triangle support、(0)Base、(1)shorter Square tube and (2)longer Square tube.

(Pay attention to distinguish which leg and the length of 2 Square tubes)

Step2:Use M8 bolts to fix the (0)Base、other Square tubes\Triangle supports and (10) Horizontal axle.

(Install according to the numbers and in counterclockwise)

Step3:From bottom,Use 24 M4 Stainless Bolts to fix (12)the Workpiece table sealing board and the base as shown in the figure below.(fixed with 24 M4 Stainless Bolts)

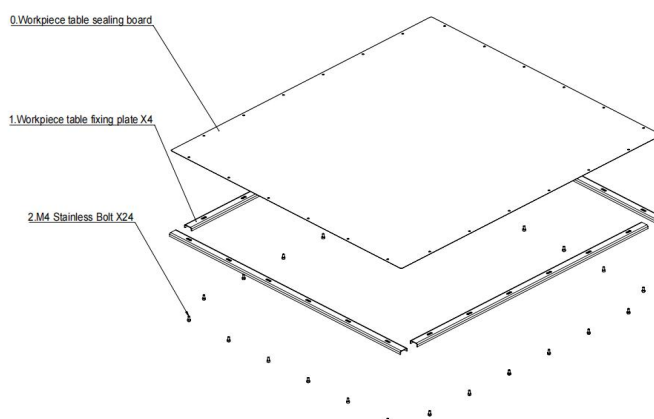

Step4:Rotate Horizontal axle to be perpendicular to the main Axle,then fix with 4 M6 Hexagon socket screws.